

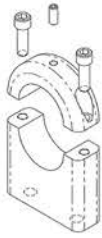

1-800-648-8022
www.flamingriver.com



Universal Pillow Block Mounts clamp to rack tube and allow you to rotate rack for best pinion angle to connect steering linkage.

Custom Front Steer Pillow Block Mount Manual Rack and Pinion Worksheet

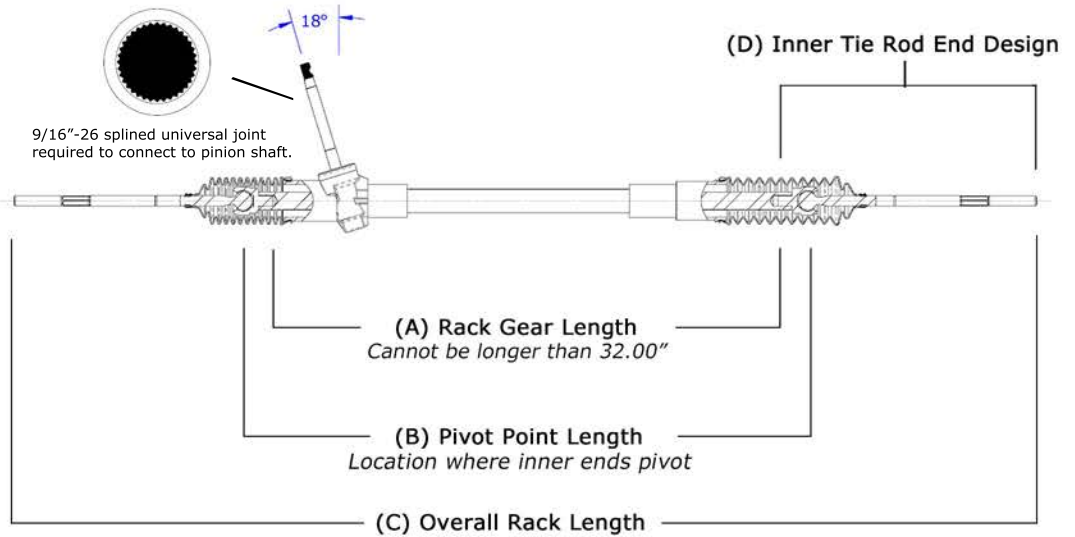

PLEASE FILL IN YOUR CUSTOM MANUAL RACK AND PINION SPECS

- (A) Rack Gear Length: _____
- (B) Pivot Point Length: _____
- (C) Overall Rack Length: _____
- (D) Inner Tie Rod Ends (9/16"-18 thread is standard):
 - Male / Female (circle one)
 - Thread: _____
- Pinion Shaft:
 - Standard Pinion Shaft (7.44")
 - Short Pinion Shaft (1.50")
- Additional Notes: _____

Flaming River has created stocked part numbers for some of the most popular late-model muscle car vehicles:

	Overall Length	Pivot Points	Mounts
2005-2014 Mustang			
FR1515	54.50"	30.03"	14.00"
2015-2016 Challenger			
FR1515MPR16	51.25"	26.01"	18.21"
2016 Camaro			
FR1515CAM16	49.00"	30.25"/30.38"	11.75"

Flaming River manufactures custom racks to customer specifications per the above diagram. Flaming River Industries assumes no responsibility for design integrity. Design and fitment of the manual rack and pinion is the responsibility of the customer.

Payment: Full payment is required with order. Cash, Visa, MasterCard, Discover, or PayPal are accepted.

Cancellation: Custom racks are non-cancelable and non-returnable. Rack specifications must be in writing and signed by customer.

Delivery: 4-6 weeks from time of order

CUSTOMER CONTACT INFORMATION

*Contact Name: _____
 Company Name (if applicable): _____
 *Address: _____
 *City, State, Zip: _____
 *Phone: _____ Fax: _____
 *Email: _____
 *Signature: _____ *Date: _____

- * Indicates required field.

INTERNAL USE

Sales: _____
 Production: _____
 Builder: _____
 Checked By: _____
*Initial and Date

Flaming River Industries, Inc.
 800 Poertner Drive
 Berea, OH 44017

P: 1-800-648-8022
F: 1-800-243-5263
info@flamingriver.com