

## Electro-Wizard® with Insulated Solenoid

**FR1052**

### Features & Benefits

- Insulated solenoid design to work with both positive & negative disconnect methods on 12V systems
- Passive magnetic solenoid operation - never forget about deactivating a manual switch again
- Activate the main switch with a single button press
- Use 3 & 6 minute time delay relays (sold separately) with the Electro-Wizard® for automatic shutoff
- 250 Amp continuous current rating
- 2500 Amp surge rating for 3 seconds
- Sealed water resistant design can withstand severe operating conditions

### Ideal Protection Applications

- Construction, Mining, Agricultural, & Off-Highway Equipment
- Heavy-Duty Trucks & Class 8 Vehicles
- Automotive & Racing
- Marine
- DEF System Compatible

### Dimensions

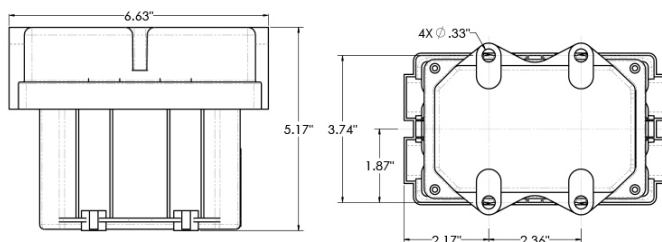

**NOTE:**

Time Delay Relay Modules sold separately:

- **FR1053** - 3 Minute Time Delay Relay
- **FR1055** - 6 Minute Time Delay Relay



### Specifications

Voltage	12V
Max Continuous Current	250 Amps @ (74°F/23°C)
Max Surge Current	2500 Amps (3 seconds)
Environmental Protection	IP65
Water Resistant	Yes
Corrosion Resistance	Salt Spray Test: 300 hours
Operating Temperature	-40°F to +185°F (-40°C to +85°C)
Internal Contacts	Silver-Plated Copper
Contact Terminals	Tin-Plated Brass
Contact Hardware	Nickel-Plated Brass
Stud Diameter	M10
Available Stud Length	0.89 in (approx. 57/64 in)
Max Torque (M10 Nuts)	11-13 ft-lbs
Max Torque (M5 Nuts)	1.18 ft-lbs
Battery Disconnect Mode	Positive & Negative
Warranty	1 Year

### Kit Includes

- 1, Electro-Wizard® with Insulated Solenoid
- 1, Cover for Main Unit
- 2, Terminal Covers
- 2 each, M10 Nuts, Lock, & Flat Washers
- 2 each, M5 Nuts, Lock, & Flat Washers