

## Combination Battery & Alternator Kill Switch

**FR1013**

### Features & Benefits

- Designed to shut down the battery and charging system in emergency situations
- Durable spring-loaded function allows for simple twist ON, push OFF activation
- Four auxiliary quick-disconnect terminals on the bottom for additional switching functionality
- Ideal for racing, vehicle storage, marine, & RVs
- Meets IHRA, NHRA, & SCCA sanctioning body requirements
- 150 Amp continuous current rating for 12V to 24V systems
- Supports 120 Amp alternators

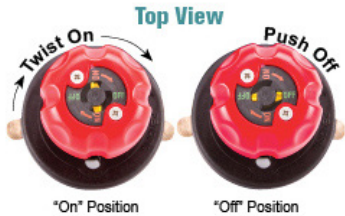

### Applications

- Emergency quick-disconnect device
- Battery & alternator disconnect
- Helps prevent battery drain
- Theft deterrent

### Dimensions

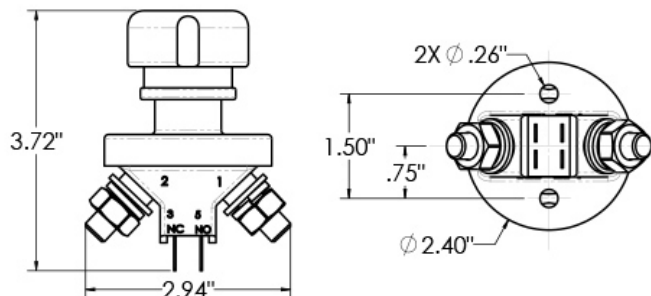

**NOTE:**  
Switch terminal covers are recommended, but not included.



### Specifications

Voltage	12V/24V
Max Continuous Current	150 Amps
Max Surge Current	1200 Amps
Max Current Aux. Terminals	5 Amps
Alternator	120 Amps
Environmental Protection	IP65
Water Resistant	Yes
Operating Temperature	-22°F to +140°F (-30°C to +60°C)
Contact Terminals	Silver-Plated Copper
Contact Hardware	Brass
Terminal Diameter	M10
Terminal Length	0.813 in (approx. 13/16 in)
Max Tightening Torque	11-13 ft-lbs
Warranty	1 Year

### Kit Includes

- 1, Combination Battery & Alternator Kill Switch
- 1, 3 Ohm Resistor
- 2 of each, 1/4-20 x 7/8" Hex Bolts, 1/4-20 Nylock Nuts, & 1/4 Flat Washer
- 2 of each, M10 Nuts, Lock, & Flat Washers