



Flaming River Ind.  
800 Poertner Dr  
Berea, OH 44017  
800-648-8022

*73-87 Chevy. C-10  
Rack and Pinion  
Conversion Kit*



**For safety, disconnect battery cables and ensure that vehicle is properly supported by jack stands.**

**NOTE: Power Steering Line Kit (FR1610) is sold separately and is not included in this kit.**

**Before paint or powder coating of the rack and pinion cradle system we recommend that you pre-fit the system to ensure proper fit.**

**NOTE: A front end alignment is necessary after installation.**

**NOTE: Flaming River Recommends that you use synthetic or high grade power steering fluid.**

Kit Inventory .....	pg 3
Original System Removal.....	pg 4-6
Rack and Cradle Installation .....	pg 7-8
Tilt Column Installation .....	pg 9
Universal Joint and Steering Shaft Installation .....	pg 10
Steering Wheel Installation .....	pg 11
Power Steering Pump Installation .....	pg 12-13
Power Steering Bleeding Procedure .....	pg 14
Additional Installation Products .....	pg 15

**WARRANTY DISCLAIMER: Flaming River's® Limited Warranty**

Flaming River® warrants its products to be free from defects in material and workmanship for a period of one (1) year after the date of purchase, except that: All steering columns are warranted for a period of three (3) years from the date of purchase. The Big Switch (part number FR1005) is warranted for a period of three (3) years from the date of purchase, provided that it is not mounted with a steel bracket and provided further that it is adequately protected from environmental conditions. All electrical products other than the Big Switch are warranted for a period of ninety (90) days from the date of purchase. Flaming River's® warranty liability is limited to the replacement of defective products. Flaming River® is not liable for any labor costs associated with any warranty claim, or for any incidental or consequential damages. Improper installation, abuse, racing, and/or modification of the products voids this warranty. No warranty of merchantability or fitness for a particular purpose is made by Flaming River® with respect to any of its products. Warnings and Recommendations It is the customer's responsibility to determine the suitability of a given Flaming River® product for the customer's uses. Likewise, it is the customer's responsibility to install a Flaming River® product. Contact the vehicle manufacturer whenever installing a switch to confirm the appropriateness of using such a switch and the recommended placement of the switch on the vehicle. Use qualified chassis specialists for the installation of all steering related components. Be aware that the installation of certain Flaming River® products may adversely impact a manufacturer's warranty with respect to certain vehicles and other manufactured goods. Flaming River will repair or replace any product found to be defective in material or workmanship. Improper installation, abuse, racing and/or modification VOID WARRANTY. Flaming River® is not responsible for any labor costs associated with any warranty.

Item No.	Part No.	Description	Qty
1	100436	C-10 Power Rack and Mounting Cradle Assembly	1
2	FR1614	Power Steering Fluid Reservoir	1
3	BK10200	Support Bearing Bracket, Bent	1
4	FR1810	3/4" Zinc Support Bearing	1
5	FR1850	18" Length of 3/4" DD Shaft	1
6	FR1920	3/4" DD X 3/4" DD Universal Joint	1
7	FR1934	1" DD X 3/4" DD Universal Joint	1
8	FR1969	FR Power X 3/4" DD Universal Joint	1
9	FRPMP5B-V	Power Steering Pump w/ V-Belt Pulley	1
10	FR20300	Stramp Clamp	1
11	FR30106	73-87 GMC Truck Gear Shift Key Column	1
12	BOLT-3/8-16X1	1" Long 3/8"-16 Grade 8 Bolt	2
13	BOLT-7/16-14X1	1" Long 7/16"-14 Grade 8 Bolt	3
14	NUT-3/8-16	3/8"-16 Nylock Lock Nut	2
15	NUT-7/16-14	7/16"-14 Nylock Lock Nut	3
16	WASH-3/8"	3/8" Flat Washer Grade 8 Equ	4
17	WASH-7/16"	7/16" Flat Washer Grade 8 Equ	6
18	FR20118	Female Connector Kit	1

*1973-87 Chevy-C-10  
Cradle and Shaft  
Assembly-Power*

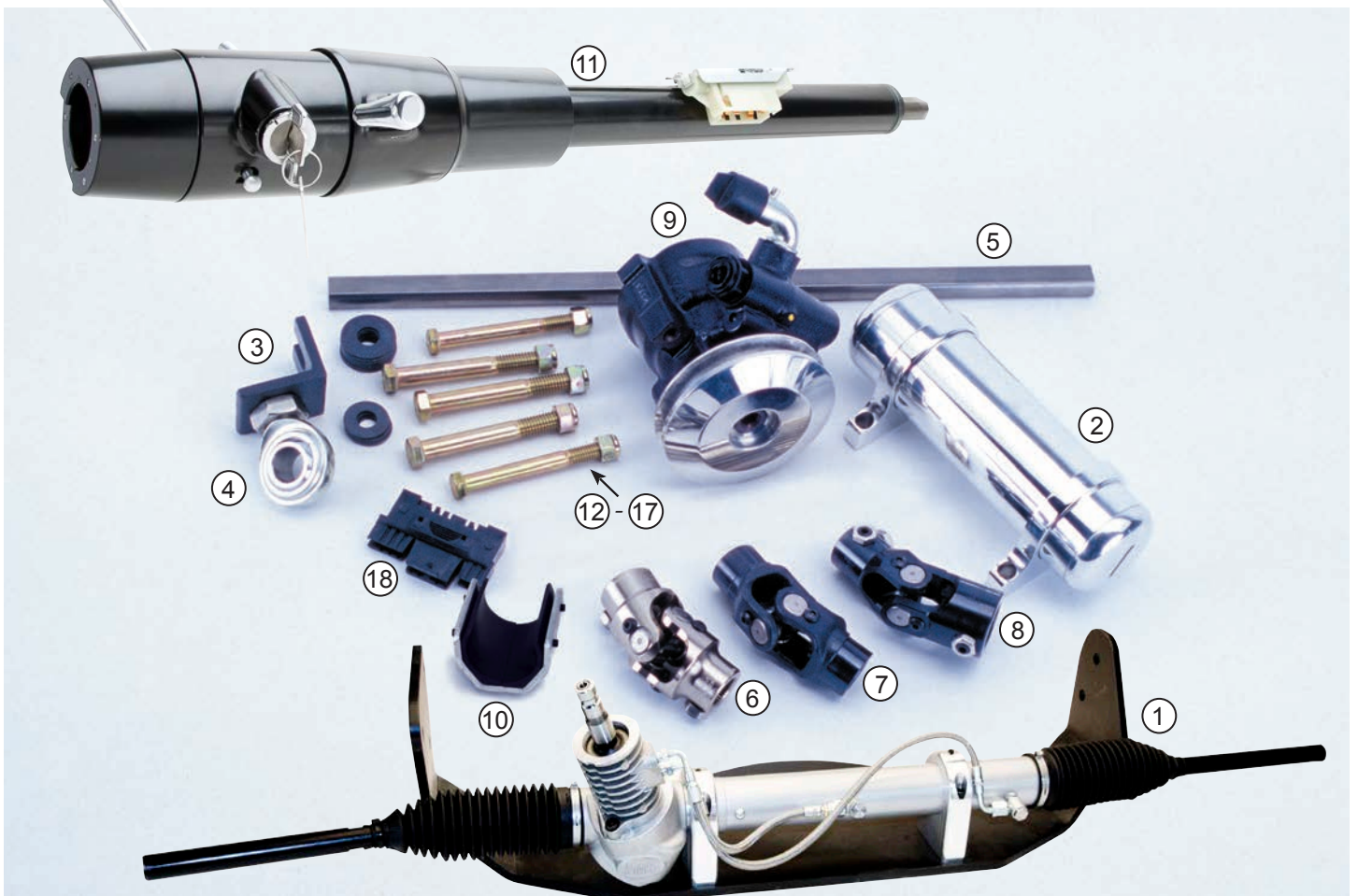

# Removing Original Steering System



Before beginning you must first measure the width of your front end from LEFT outer tie rod end zerk to the RIGHT outer tie rod end zerk to determine the overall width of your front end. Write dimension here for further reference \_\_\_\_\_

Caution: Before disconnecting your original steering column wiring harness please verify each wire color and function on the worksheet below. Some wire colors may vary from year to year.

## Flaming River Column Wiring

P-White-Brakelight Switch  
 N-Dk Green-Rr Turn Signal  
 M-Yellow-Lr Turn Signal  
 L-Purple-Turn Signal Power  
 K-Brown-Hazard Power  
 J-Dk Blue-Rf Turn Signal  
 H-Lt Blue-Lf Turn Signal  
 G-Black-Horn

## Color Verification to be completed before disassembly

• Brake Light Switch : \_\_\_\_\_  
 • RR Turn Signal : \_\_\_\_\_  
 • LR Turn Signal : \_\_\_\_\_  
 • Turn Signal Power : \_\_\_\_\_  
 • Hazard Power : \_\_\_\_\_  
 • RF Turn Signal : \_\_\_\_\_  
 • LF Turn Signal : \_\_\_\_\_  
 • Horn : \_\_\_\_\_

## Original Steering Shaft Removal



Remove the pinch bolt that retains the steering coupler to the steering column and the bolt that retains the rag joint to the steering box. Collapse shaft and remove it from the car.

## Original Column Removal

*Only perform these steps if using a new Flaming River Steering Column*

- 1) Disconnect the column wiring connectors.
- 2) Remove the bolts that hold the column floor mount to the firewall.

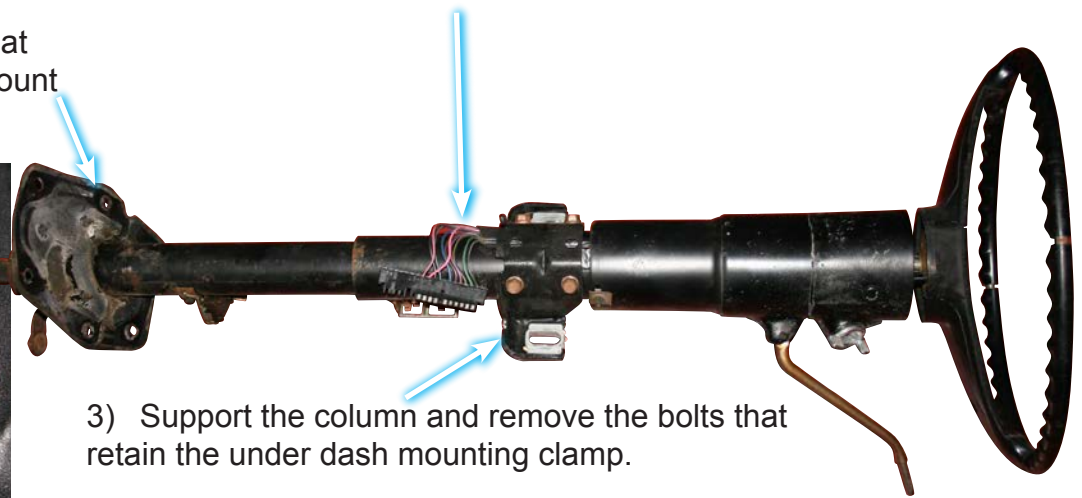
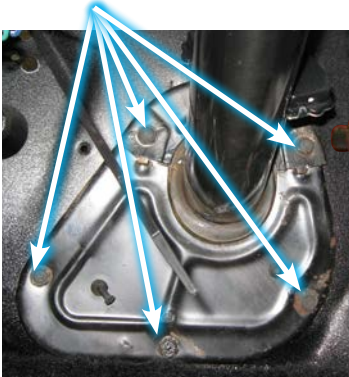

- 3) Support the column and remove the bolts that retain the under dash mounting clamp.
- 4) Remove the factory steering column from the vehicle.

## Steering Box and Linkage Removal

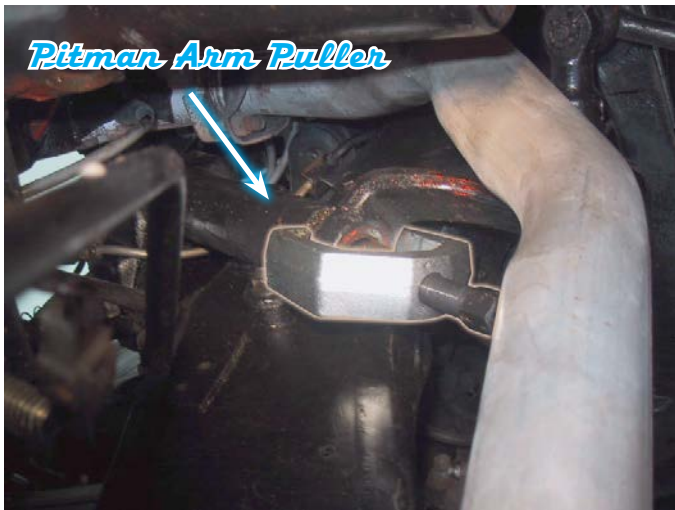

1) Remove the pitman arm nut and then the pitman arm from the steering box using a pitman arm puller.

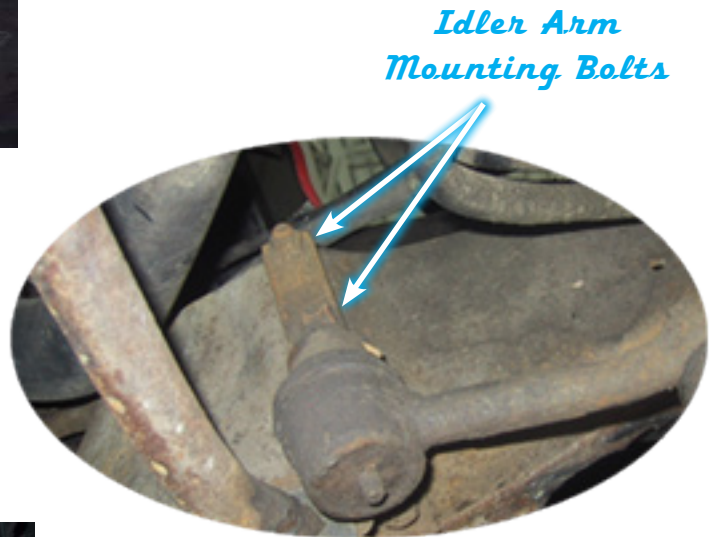

2) Remove the two bolts that retain the idler arm to the frame rail.



3) Remove the cotter pins and castle nuts and separate the outer tie rod ends from the spindles.



4) Next, remove the steering linkage from the car.

5) If you have power steering, remove the lines from your power box, pump and pump brackets.

6) Remove the three bolts that retain the box to the frame rail and remove the box from the car

## Flaming River Rack and Pinion Cradle Installation

1) Remove the Rack from the cradle.

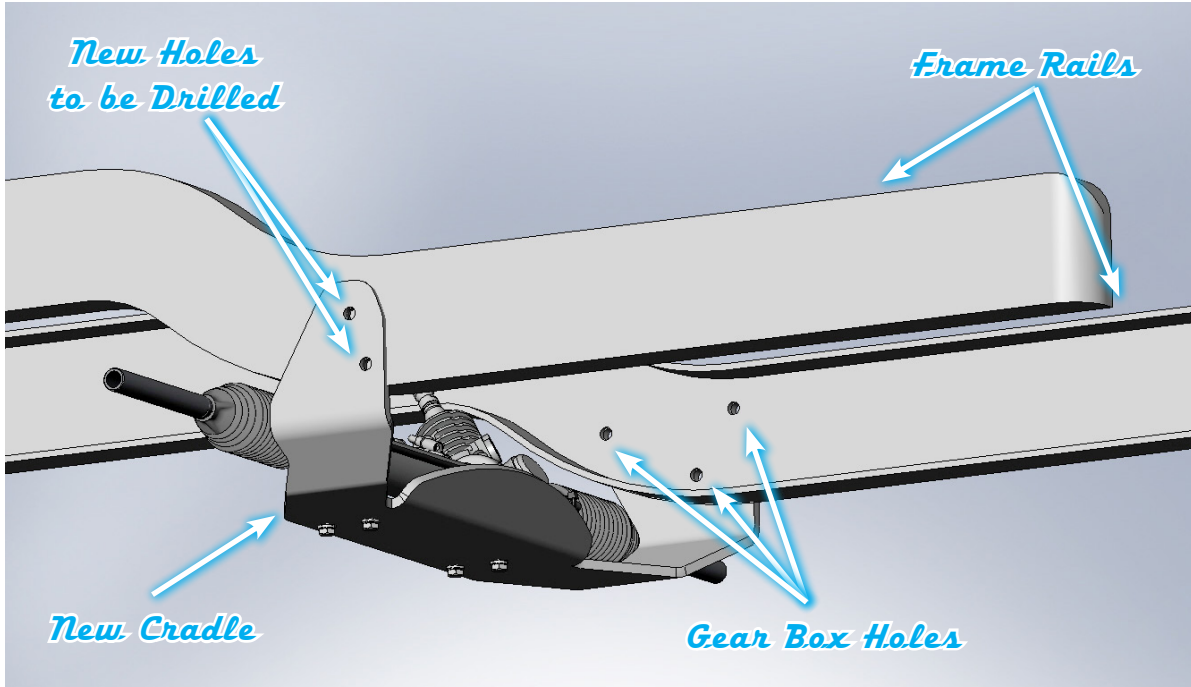

2) Install the rack and pinion cradle by sliding it over the frame rails



3) Installing the new hardware using three 7/16" bolts where the gear box was mounted and tighten the 7/16" nuts and bolts to 50-65 ft lbs.

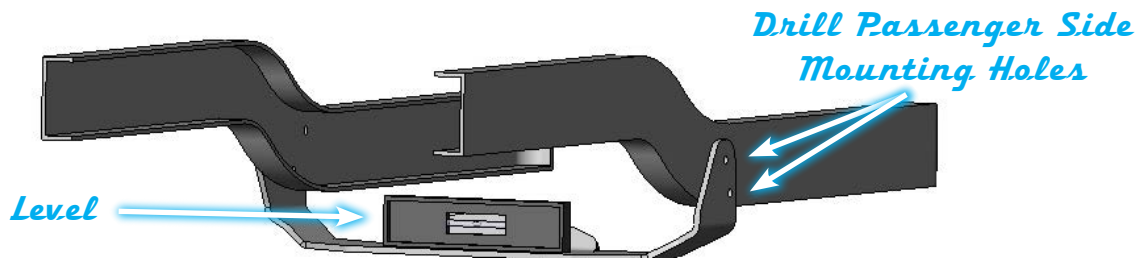

4) Next place a level on the cradle and the level the cradle. Once the cradle is level, then mark and drill the passenger side mounting holes.

## Flaming River Rack and Pinion Cradle Installation (Continued)



5) Install the new hardware using two 3/8" bolts in the newly drilled holes on the passenger side and tighten the bolts to 40-45 ft lbs.

6) Re-install the power rack and pinion onto the cradle.

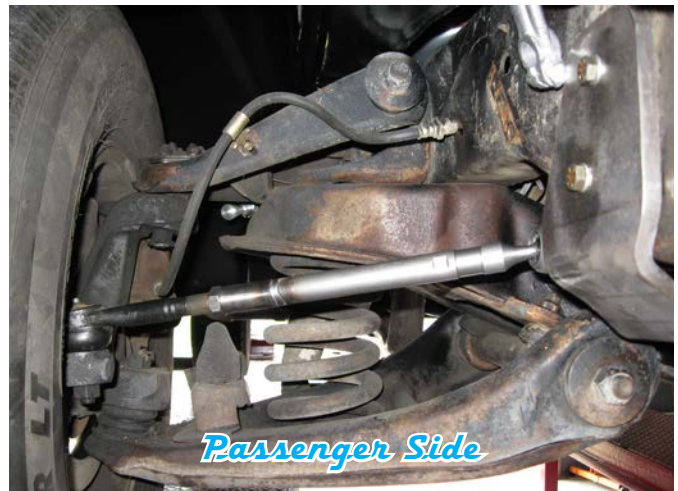

7) Install the outer tie rod ends into the inner tie rod ends and adjust tie rods until the original zerk to zerk measurement taken before disassembly is obtained. \_\_\_\_\_ (Measurement from page 4). To install the outer tie rod ends into the spindles you must load the front suspension. (Securely placing jack stands under the lower control arms and lowering the car onto the jack stands accomplishes this.) Install the outer tie rod ends into the spindle and tighten the castle nuts to 30-40 ft lbs. Make sure to install cotter pins into the castle nut and tie rod end and bend the tabs over for security.

Note: The new Flaming River Rack and Pinion has been centered in its travel from the factory. If the rack becomes off center it will turn more in one direction than the other. When performing the front end alignment, adjust your toe by rotating the inner ends only. You may have to re-center the steering wheel. To re-center the steering wheel: remove the wheel and adapter from the column and re-install in the straight position.



## Flaming River Column Installation

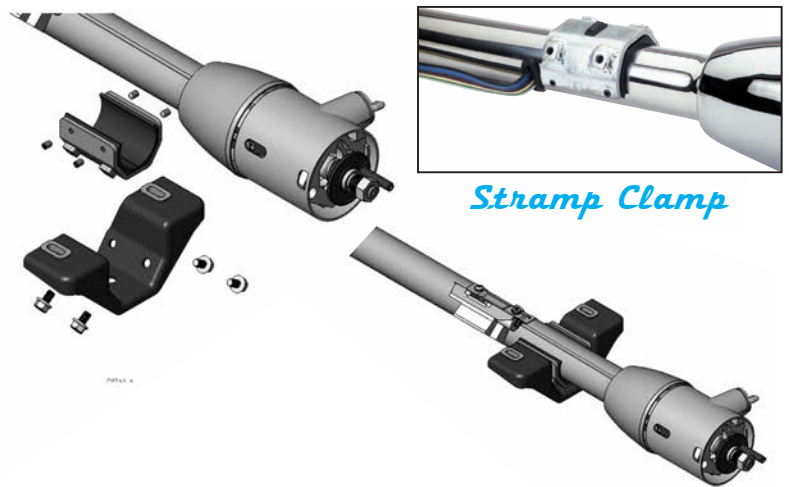

- 1) Slide the new steering column through the opening in the original floor mount, and then slide the column through the opening in the firewall.
- 2) Hold the original mounting bracket from the vehicle around the column so that the mounting holes line up with the frame and determine where the column clamp needs to be placed on the column. Once this is determined place the set screws in the sides of the column clamp as shown. Tighten until the screws are snug but not cutting thru the rubber membrane or you will run the risk of scratching or marring the tube.
- 3) Mount the column clamp to the original mounting bracket using the original hardware (5/16-18 bolts) and then mount the bracket to the frame under the dash.

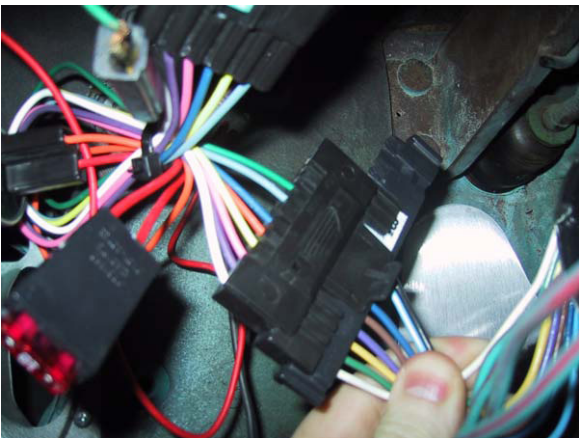

4) Install the wiring connector according to the diagram below.

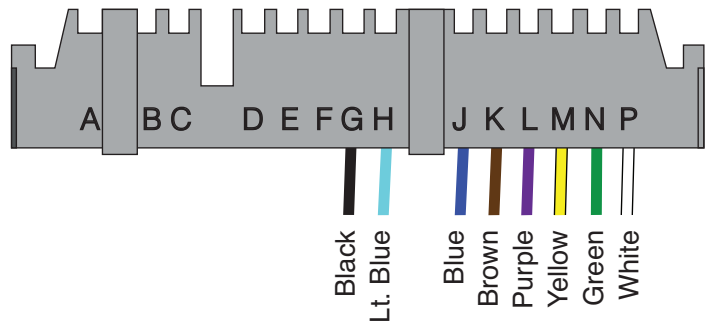

*Flaming River Column Wiring*

### Flaming River Column Wiring

<u>Wiring Circuit</u>	<u>Pin Location</u>	<u>Column Wiring Color</u>
Brake Light Switch	P	White
Right Rear Turn Signal	N	Dark Green
Left Rear Turn Signal	M	Yellow
Turn Signal Power	L	Purple
Hazard Power	K	Brown
Right Front Turn Signal	J	Dark Blue
Left Front Turn Signal	H	Light Blue
Horn	G	Black

**Color Verification to be completed before disassembly**

- Brake Light Switch : \_\_\_\_\_
- RR Turn Signal : \_\_\_\_\_
- LR Turn Signal : \_\_\_\_\_
- Turn Signal Power : \_\_\_\_\_
- Hazard Power : \_\_\_\_\_
- RF Turn Signal : \_\_\_\_\_
- LF Turn Signal : \_\_\_\_\_
- Horn : \_\_\_\_\_

## Universal Joint System

**\*\* We recommend that you regularly inspect the u-joint set screws for tightness. \*\***

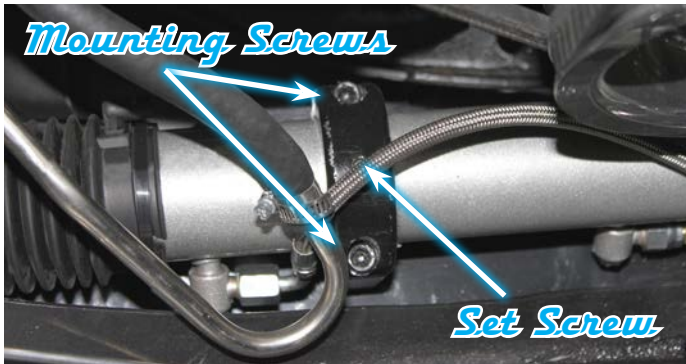

1) Loosen the set screws in the rack mounting blocks. – This will allow to you to adjust the pinion angle for proper u-joint alignment.

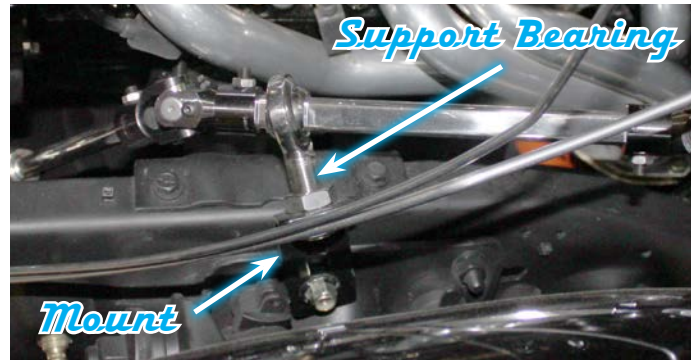

2) Install support-bearing mount onto the inner front control arm bolt. (Picture below). Note: The angle of this mount is set for most applications. Some adjustment may be necessary for the correct angle and u-joint alignment.

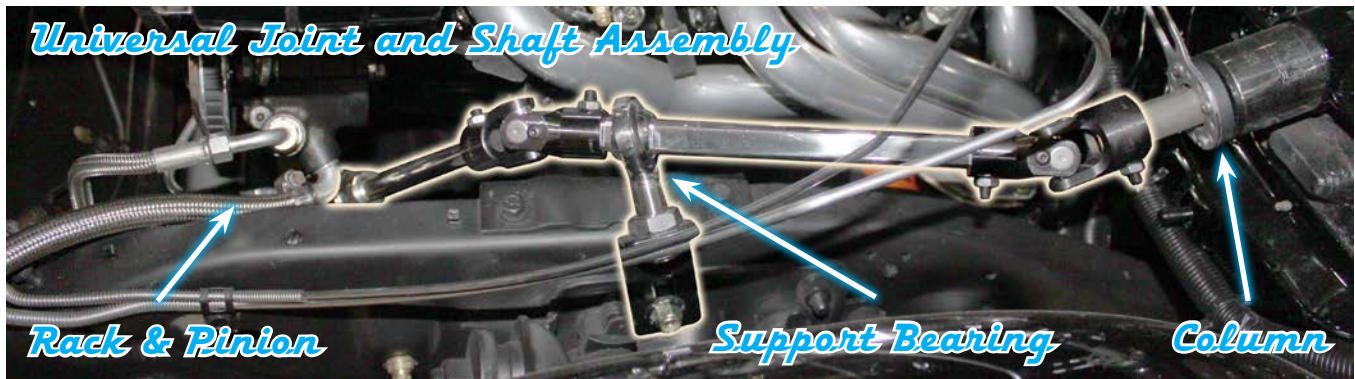

3) We recommend the use of  $\frac{3}{4}$ " wood dowel rod to mock up the steering shaft to obtain the correct length of the shafts.

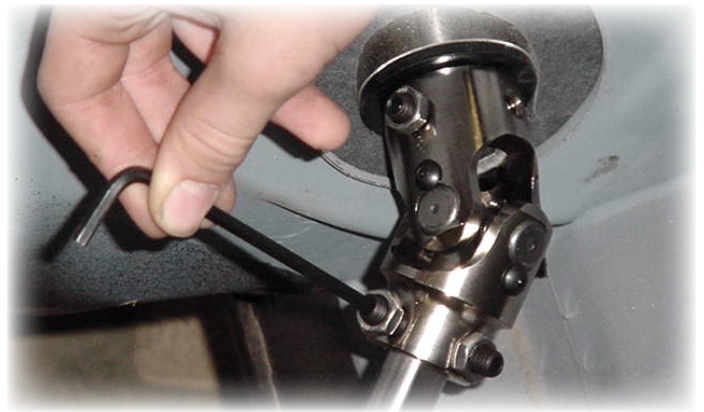
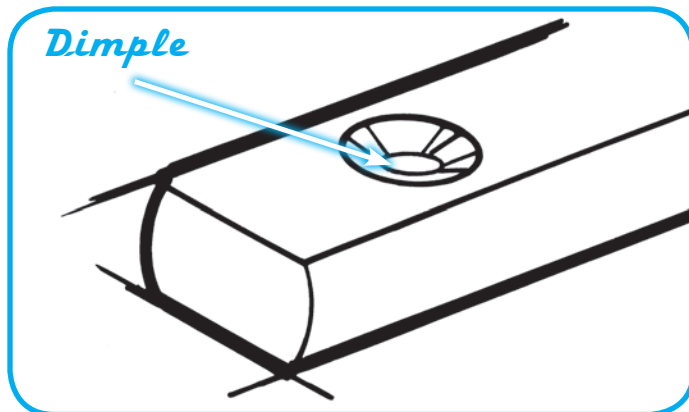

4) Install your shaft kit and snug each set screw so that it will leave a mark in the shafts.

5) Remove shaft and dimple each setscrew mark using a  $\frac{1}{4}$ " drill bit. (As shown below.)

6) Re-install the shafts using red loc-tite thread locker on the set screw threads. Tighten each setscrew to 25 ft. lbs. Tighten all lock nuts securely. We recommend that you inspect setscrews periodically for tightness.

7) Re-tighten the set screw that was loosened in the rack mounting blocks in step #1.

## Steering Wheel Installation

**Note: Before installing the steering wheel, make sure the wheels are straight.**

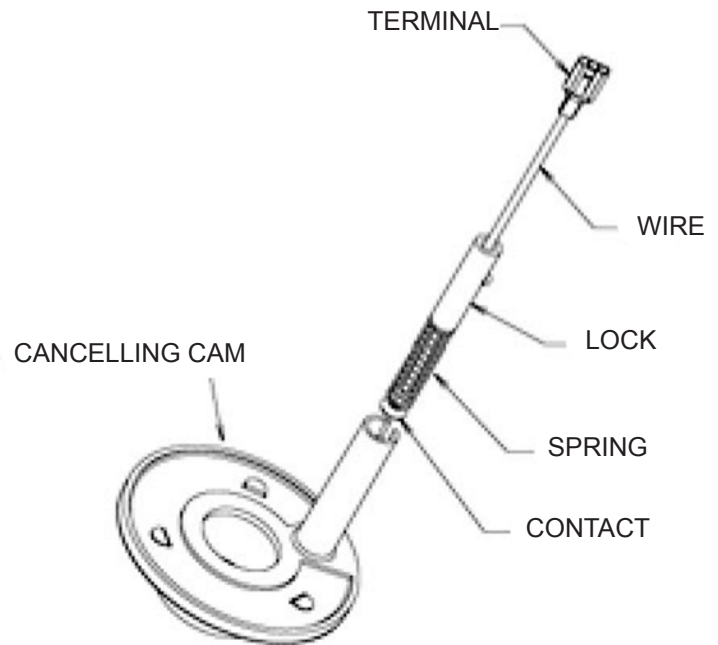
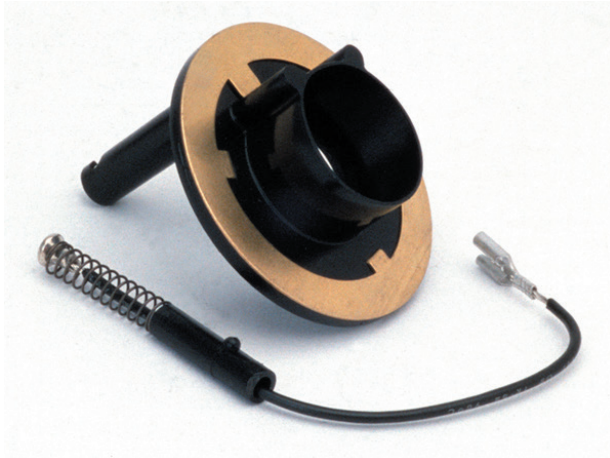

1) Install horn contact kit into canceling cam tube and turn to lock (Included with column).

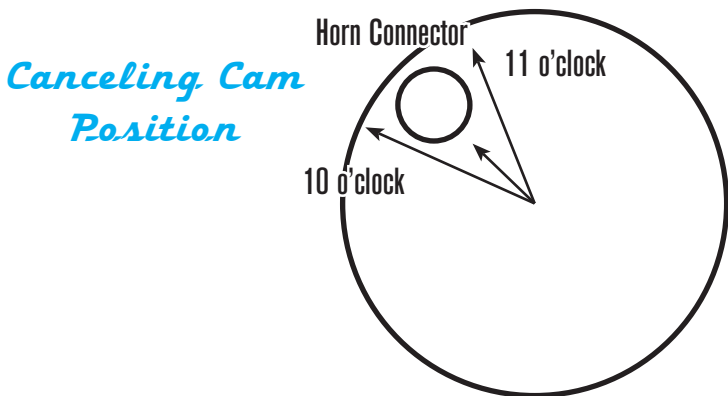

2) Align steering wheel adapter so that the canceling cam hole is at approx the 11 o'clock position and that one of the steering wheel mounting holes is at the 12 o'clock position.

3) To install the wheel adapter run the horn contact wire through the hole for the canceling cam and place the adapter on to the splined column shaft.

4) Tighten the adapter-retaining nut until the adapter is approximately 1/16" away from the column shroud.

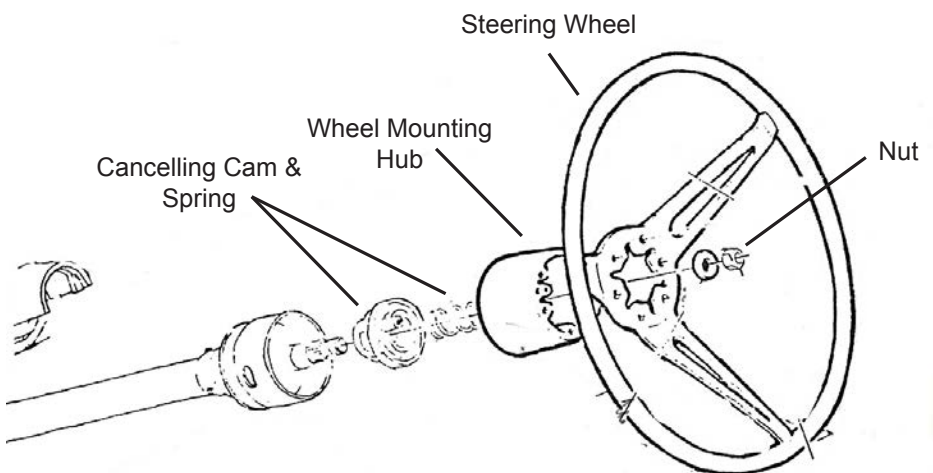

# FR1612 Small Block Chevy Power Steering Pump Bracket

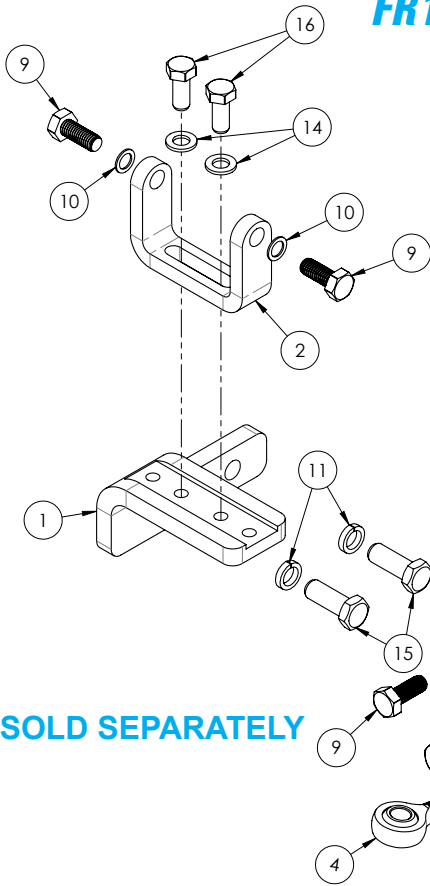

ITEM NO.	QTY.	PART NUMBER	DESCRIPTION
1	1	100632	BRACKET, MOUNT PUMP-MOTOR SB
2	1	100633	BRACKET, MOUNT PUMP PS
3	1	100667	HEIM JOINT, END ROD 3/8-24 RH
4	1	100668	HEIM JOINT, END ROD 3/8-24 LH
5	1	100720	SPACER, ADJ 0.62 X 2.52 W/ 3/8-24 RH-LH
6	1	100721	SPACER, 0.392 X 0.62 X 1.00 ALUM
7	1	100722	BOLT, 3/8-16 X 3.00 HEX HD GR8
8	1	100723	WASHER, FLAT 0.39 X 0.62 X .05
9	3	100724	BOLT, M8 X 1.25 X 20 HEX HD GR10.9
10	3	100725	WASHER, FLAT 0.32 X 0.47 X .04
11	2	100726	WASHER, LOCK SPLIT 3/8 HIGH COLLAR
12	1	100728	NUT, 3/8-24 JAM LH
13	1	100729	NUT, 3/8-24 JAM RH
14	2	100730	WASHER, FLAT 0.32 X 0.57 X .06
15	2	100779	SCREW, 3/8-16 X 1.00 HEX HD GR8
16	2	102725	SCREW, 5/16-18 X .75 HEX HD GR8

**SOLD SEPARATELY**



800 Poertner Dr., Berea, Ohio 44017 • 1-800-648-8022

## Power Steering Pump Installation/Small Block Chevy



Install L-shaped bracket (1) on engine with bolts (15) and lockwashers (11) supplied



Install pump bracket (2) to L-shaped bracket (1) with bolts (16) and washers (14) supplied



Install pump to bracket (2) using bolts (9) and washers (10) supplied



Install adjuster to pump using bolt (9) and washer (10) supplied



Remove upper water pump bolt. Install spacer (6) and adjuster with bolt (7) and washer (8) supplied

# FR1613 Big Block Chevy Power Steering Pump Bracket

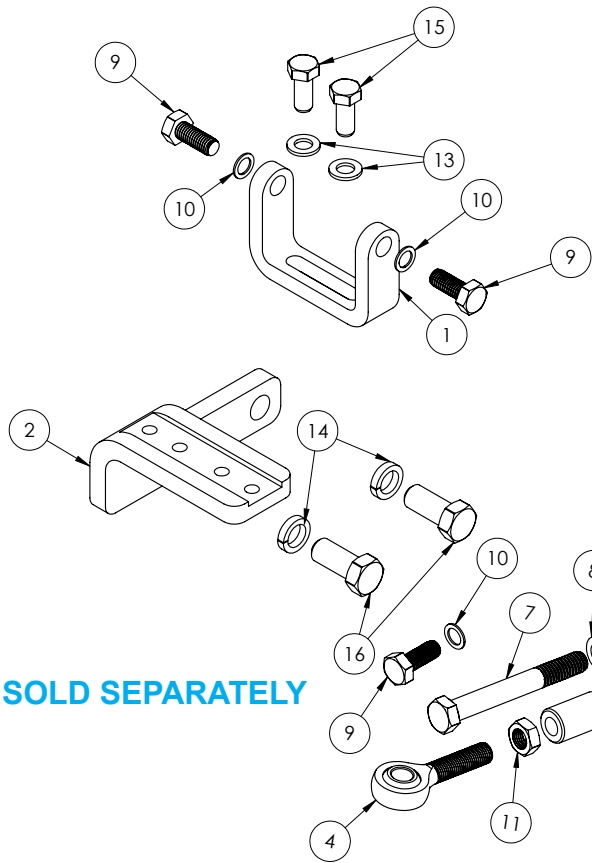

ITEM NO.	QTY.	PART NUMBER	DESCRIPTION
1	1	100633	BRACKET, MOUNT PUMP PS
2	1	100649	BRACKET, MOUNT PUMP-MOTOR SB
3	1	100667	HEIM JOINT, END ROD 3/8-24 RH
4	1	100668	HEIM JOINT, END ROD 3/8-24 LH
5	1	100720	SPACER, ADJ 0.62 X 2.52 W/ 3/8-24 RH-LH
6	1	100721	SPACER, 0.392 X 0.62 X 1.00 ALUM
7	1	100722	BOLT, 3/8-16 X 3.00 HEX HD GR8
8	1	100723	WASHER, FLAT 0.39 X 0.62 X .05
9	3	100724	BOLT, M8 X 1.25 X 20 HEX HD GR10.9
10	3	100725	WASHER, FLAT 0.32 X 0.47 X .04
11	1	100728	NUT, 3/8-24 JAM LH
12	1	100729	NUT, 3/8-24 JAM RH
13	2	100730	WASHER, FLAT 0.32 X 0.57 X .06
14	2	100732	WASHER, LOCK SPLIT 7/16 HIGH COLLAR
15	2	102725	SCREW, 5/16-18 X .75 HEX HD GR8
16	2	BOLT-7/16-14X1	BOLT, 7/16-14 X 1.00 HEX GR8

**SOLD SEPARATELY**



800 Poertner Dr., Berea, Ohio 44017 • 1-800-648-8022

## Power Steering Pump Installation/Big Block Chevy

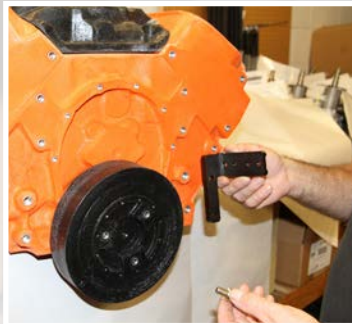

Install L-shaped bracket (2) on engine with bolts (16) and lockwashers (14) supplied



Install pump bracket (1) to L-shaped bracket (2) with bolts (15) and washers (13) supplied



Install pump to bracket (1) using bolts (9) and washers (10) supplied



Install adjuster to pump using bolt (9) and washer (10) supplied



Remove upper water pump bolt. Install spacer (6) and adjuster with bolt (7) and washer (8) supplied



# Instruction Bulletin #1021

## Correct Bleeding Procedure for Flaming River Power Rack & Pinion Systems.

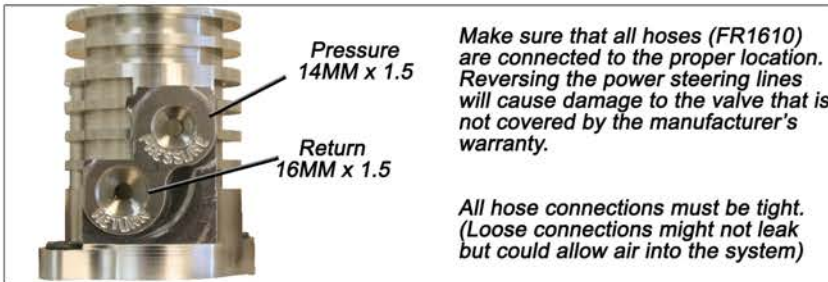

Make sure that all hoses (FR1610) are connected to the proper location. Reversing the power steering lines will cause damage to the valve that is not covered by the manufacturer's warranty.

All hose connections must be tight. (Loose connections might not leak but could allow air into the system)

**Important**

**\*\*\* Power Steering Fluid\*\*\***  
Use clean, new power steering fluid only.

- 1) Turn Ignition Off
- 2) Raise front wheels off the ground.
- 3) Turn the steering wheel full left.
- 4) Fill fluid level to "Full Cold" level or if using remote reservoir 1" over inner tube.
- 5) With assistant checking fluid level and condition, turn steering wheel lock to lock at least 20 times.
- 7) Start engine. With engine idling, maintain fluid level. Reinstall cap.
- 8) Return wheels to center. Lower front wheels to the ground.
- 9) Keep engine running for two (2) minutes.
- 10) Turn steering wheel in both directions.

Verify:  
Smooth power assist  
Noiseless operation  
Proper fluid level  
No system leaks  
Proper fluid condition  
No bubbles, no foam,  
no discoloration.

**Note:** On systems with long return lines or fluid coolers, turn steering wheel lock to lock at least 40 times.

Trapped air may cause fluid to overflow. Thoroughly clean spilled fluid to allow for leak check.

- 6) While turning wheels check fluid level constantly.
- 11) If all proper conditions apply, bleeding is complete.
- 12) If any problem remains see "Special Conditions".

**Note:** No bubbles are allowed.

For any sign of bubbles, recheck connections then repeat step 5.

### Special Conditions:



- Foam or bubbles in fluid  
Fluid must be completely free of bubbles. In step 5, be alert to periodic bubbles that could indicate a loose connection or leaky O-Ring seal in either the return hose or pressure hose.
- Discolored fluid (milky, opaque, or light tan color)

Switch ignition off. Wait two (2) minutes. Recheck hose connections. Repeat steps 7-10. If condition still exists, replace and check a possible cause:

- Return hose clamps
- Return hose o-ring
- Pressure hose o-ring
- Gear cylinder line o-rings

Fill system and repeat bleed procedure for each possible cause. Repeat steps 7-10 to verify whether noise has been eliminated.



- Pump whine or groan  
With engine running, recheck hoses for possible contact with frame body or engine. If no contact is found, follow either method below to cool down fluid and re-pressurize system.

**Method 1:**  
Normal Cool Down

Switch engine off.  
Wait for system to cool.  
Install reservoir cap.

**Method 2:**  
Partial Fluid Replacement

Switch engine off. Use a Suction device to remove fluid from the reservoir. Refill with cool, clean fluid. Install Reservoir cap.

After either method of cooling, start engine and allow engine to reach normal operating temperature. If noise persists, remove and replace power steering pump. Repeat bleed procedure following pump replacement.

### WARRANTY DISCLAIMER:

Flaming River® warrants its products to be free from defects in material and workmanship for a period of one (1) year after the date of purchase. It is the customer's responsibility to determine the suitability of a given Flaming River® product for the customer's uses. Use qualified chassis specialists for the installation of all steering related components. Be aware that the installation of certain Flaming River® products may adversely impact a manufacturer's warranty with respect to certain vehicles and other manufactured goods. Flaming River will repair or replace any product found to be defective in material or workmanship. Improper installation, abuse, racing and/or modification VOID WARRANTY. Flaming River® is not responsible for any labor costs associated with any warranty.

## Additional Installation Products

### HIGH OUTPUT ALTERNATORS



Die Cast w/Chrome Housing  
FR1108C 170 Amp  
FR1109C 240 Amp

### SMOOTH BODY SHOCKS



Front  
FR70046



Rear  
FR70048



Power Steering Hose Kit  
FR1610  
**(Recommended for Install –  
Sold Separately)**

### STEERING WHEELS



FR20163LT  
Navigator Style



FR20152LG  
Nostalgia Style



FR20130BK  
D Wheel Black

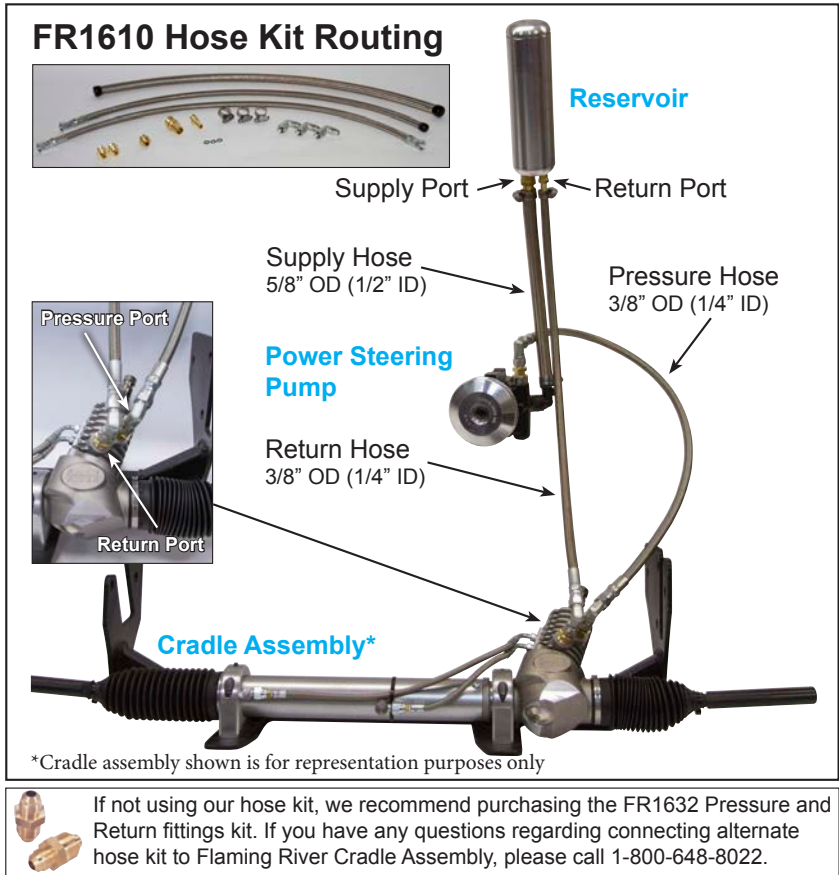

In order to ensure the best customer experience possible, we've created a Customer Satisfaction Survey to gather important feedback about different facets of our business. We would appreciate it if you could please take a couple of minutes to fill out this survey about your experience.

The results of the survey will be used to improve and gather feedback about customer service, technical and sales support, order processing and fulfillment, manufacturing, and new product development.



Upon completing the survey, you will be issued a discount coupon code to be used on your next online purchase at [www.flamingriver.com/survey](http://www.flamingriver.com/survey).



**Flaming River Ind.**  
**800 Poertner Dr**  
**Berea, OH 44017**  
**800-648-8022**